

COMPANY PROFILE



**Harness
and
Comoulding**

WE ARE

Since **1981** is a manufacturer of wiring harnesses for **automotive market** and home appliances, assembly of **electrical components** and comoulding.

Due to its policy of investment in technology, equipment and a constant focus on improvement of **quality standards**, the **CDS** has an important role to direct partner to major international companies, manufacturers of systems for the automotive market.

A FOCUS ON SUSTAINABILITY



ENVIRONMENT

Prevent and reduce impacts on the environment, operating in particular through:

- ✓ Sorting of the internal produced waste
- ✓ Recovery of the processing waste
- ✓ Control, treatment and minimization of the waste produced by the service systems
- ✓ Constant attention to emissions into the atmosphere
- ✓ Search for energy saving solutions
- ✓ Production of energy from renewable sources



SOCIAL

Promote social cohesion placing an emphasis on inclusiveness and the well-being of all.



GOVERNANCE

Make the activities carried out by the company visible and tangible.

MAIN PLANT



ITALY

Turin (Piedmont)
Gerbole Volvera



PLANT AREA 3.100 M²



**TUNISIA
GROMBALIA**



PLANT AREA 3.000 M²



GROMBALIA



Manual assembling

IDC line process

Cutting and crimping process

Automatic taping

Electrical test

PRODUCTION SITE

MAIN EXPORT COUNTRIES



Spain

India

Portugal

Germany

Brazil

Morocco

Poland

Tunisia

Turkey

PRODUCTS

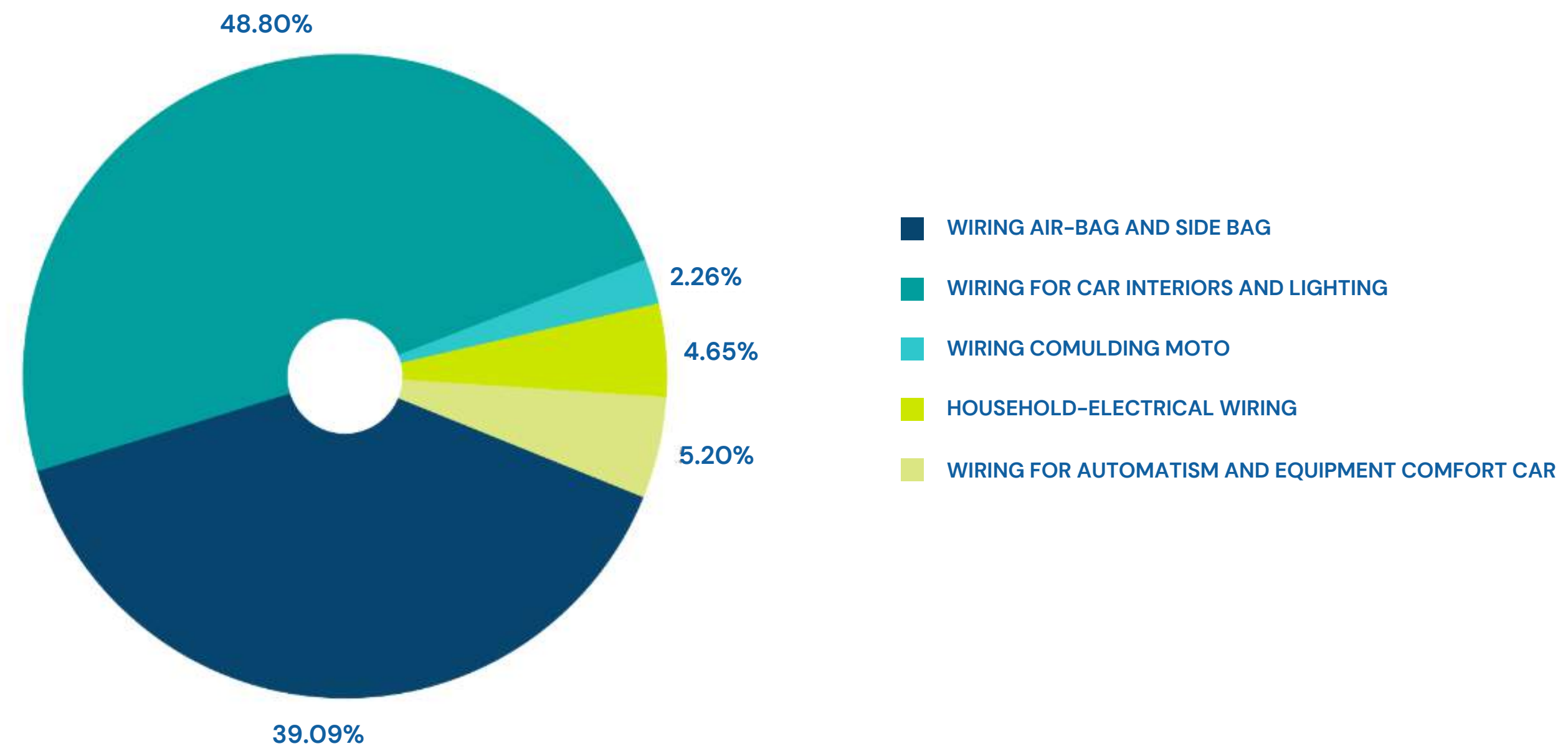

PRODUCTS



WIRING AIR BAG AND SIDE BAG



WIRING FOR CAR INTERIORS AND LIGHTING

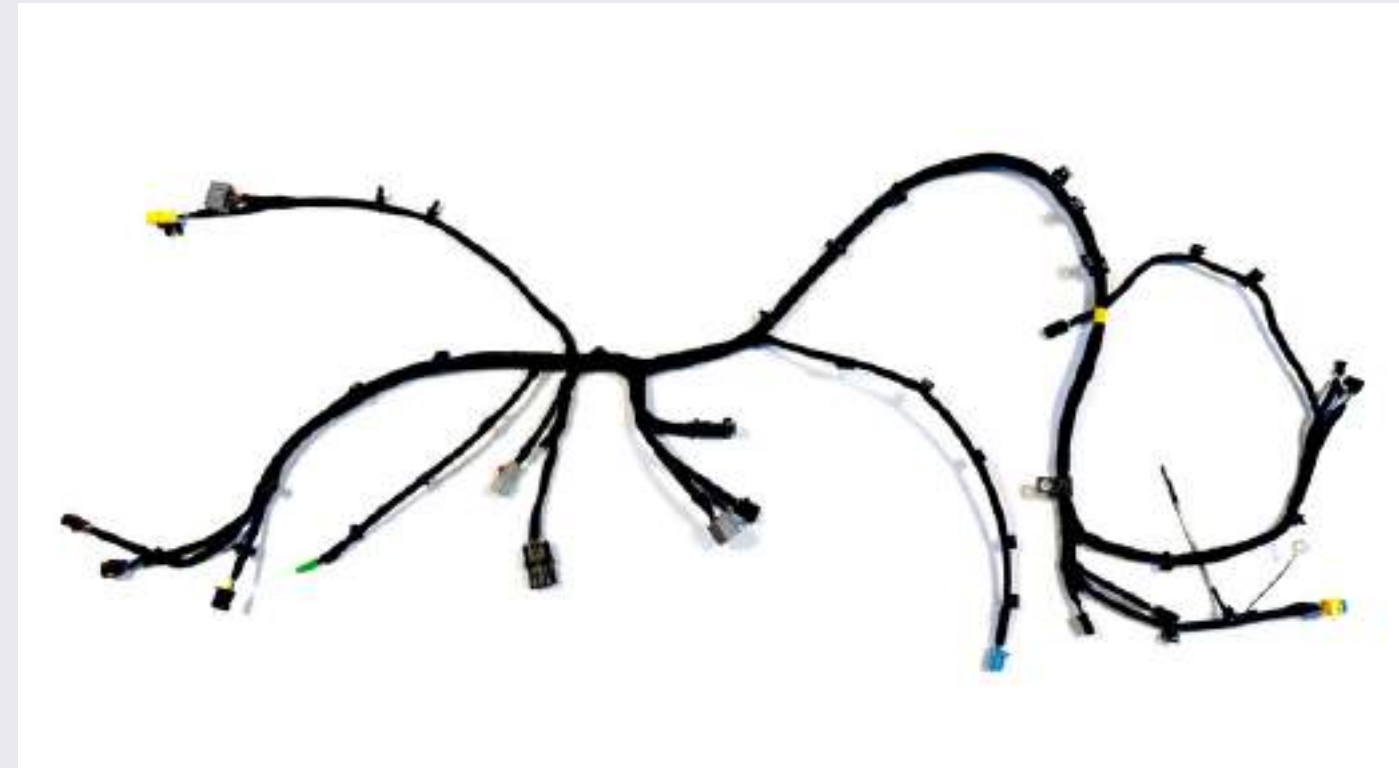

TECHNOLOGIES



Cutting - Crimping
Tinning
IDC Connector

Comoulding
Ultrasonic welding
Coating

QUALITY CONTROL

100% wiring harness test for continuity check

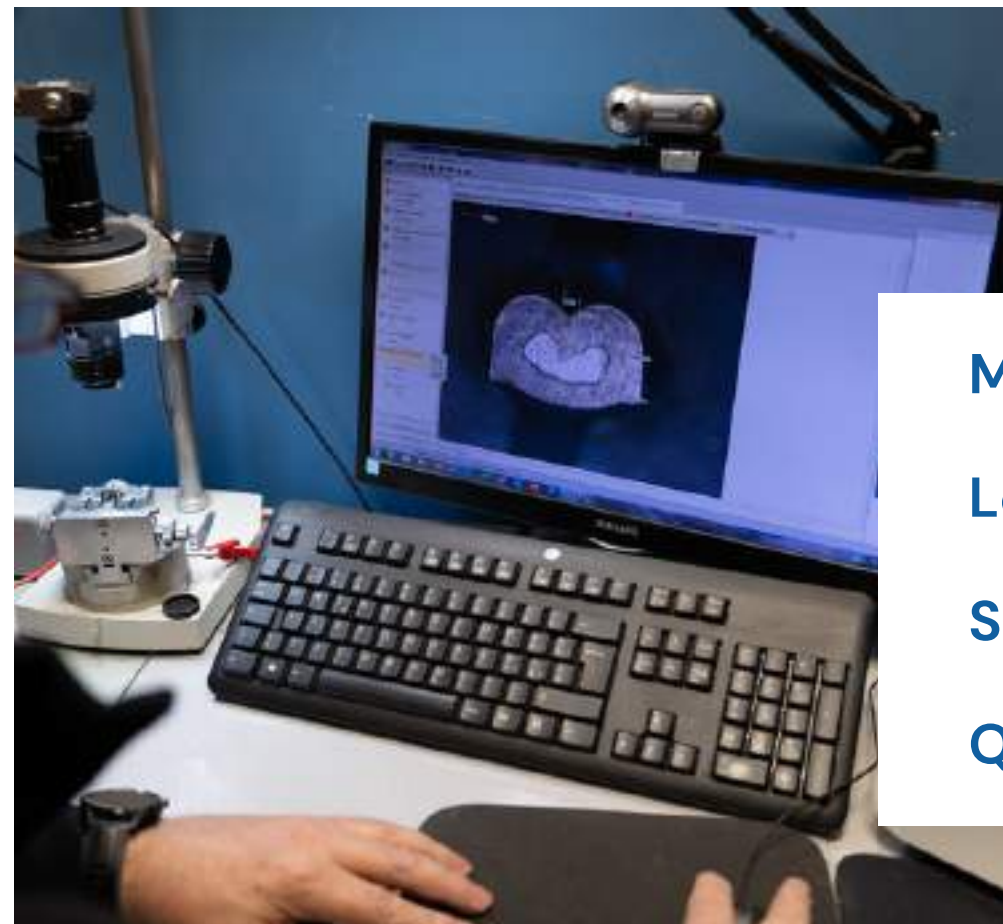

- Micrographs laboratory
- Load extraction
- Statistical controls
- Quality control cameras

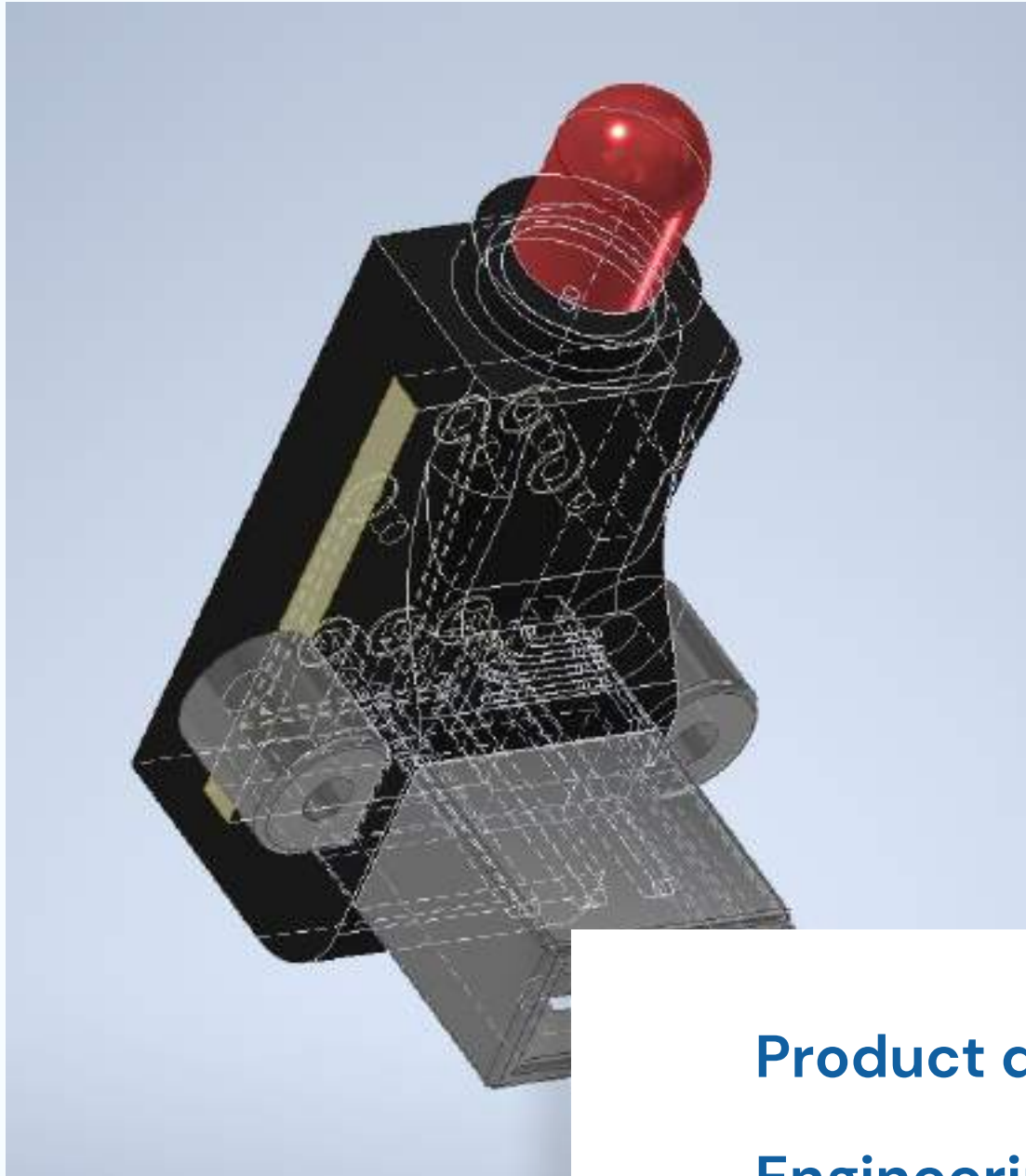

RESEARCH & DEVELOPMENT

Product development

Engineering

Design

Co-design

Fast prototyping

MAIN CUSTOMERS



O.E.M.

Our products are used by the following O.E.M.





CERTIFIED

PRODUCT SITE



EN ISO 9001:2015



CORPORATE



IATF 16949:2016

UNI EN ISO 9001:2015

UNI EN ISO 14001:2015



 + 39 011 9855400

 info@cdsharness.com

 cdsharness.com

 **Via Rivalta, 36**
10040 Fraz. Gerbole di Volvera (TO)



CONTACT US